

Proudly representing the Elsafe range of quality products.



PLUTO satisfies a demand for power and data connectivity, in informal spaces, in a way that no other module has done before. Perfectly suited to breakout areas, smaller meeting rooms, public spaces and anywhere power is needed.

With 3 outlet positions, PLUTO is perfect for a small team to power/charge their devices using conventional mains plugs. PLUTO is available in white, black and 8 vibrant gloss colours. PLUTO is also customisable with prints or logos to order.

PLUTO can be securely clamped to a standard 80mm desk grommet hole, screwed to any suitable surface, or supplied with side entry power cord and rubber feet for free standing use. PLUTO makes sharing power a pleasure.



COMMON COMPONENTS



Australia /
New Zealand



TUF-PD USB
Charger



TUF-R PD USB
Replacable Charger



TUF-R HP USB Laptop
Replacable Charger

PLUTO can be specified with a single data / AV socket

Power and Data configurations available (3 sockets)

- Power only
- Power and USB Fast Charging
- Combined (Power, USB Fast Charging & 1 single Data/ AV) socket.
- TUF-HP (high powered) USB Laptop Charging option

Insulation: QikFIT modules with reinforced insulation.

Testing: 100% testing – continuity, polarity, insulation & earth.

Soft Wiring (power)

Power wired to Wieland GST connector allows starter cables to be changed to suit requirements, especially useful during moves and changes (CHURN).

PLUTO with Wieland GST entry are rated to 20Amp

FEATURES



Colours:

Pluto is available in gloss black, gloss white and a range of gloss colours. Pluto is also customisable with matt finishes or coloured patterns on request. TUF-HP USB C laptop charging available.

Pluto mounting adaptor ring with screw fixing

Place mounting ring over 50 to 80mm hole. Screw mounting ring in place.

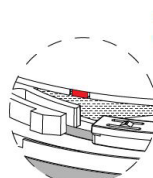
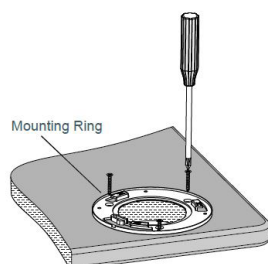

Align PLUTO with mounting ring as shown

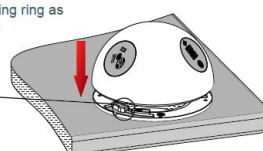

Twist PLUTO into place until you hear a 'click'

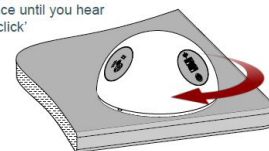

Pluto mounting adaptor ring with grommet fixing

Place mounting ring over 80mm hole. Place 80mm grommet into mounting ring and screw up retaining nut until firmly in place.

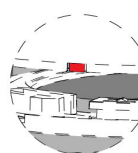
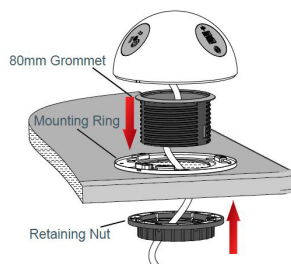

Align PLUTO with mounting ring as shown

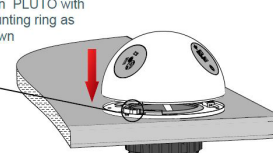

Twist PLUTO into place until you hear a click

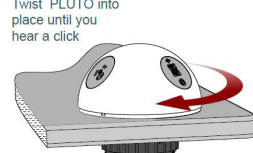

Pluto Clamp 60 Kit

PLUTO Clamp 60 comes pre fitted with bolts to ensure a more secure fixing. Place PLUTO over 60mm hole feeding the bolts through. Use the retaining plate and nuts to securely fix the PLUTO in place.

