

Proudly representing the Elsafe range of quality products.



The OE Elsafe Pathfinder system has been designed from 30 years of experience in supplying cable management products. Pathfinder offers a complete floor to desk, floor to ceiling, or ceiling to desk, vertical cable management solution.

### KEY FEATURES

- Unique PATHFINDER GROMMET for feeding under floor cables directly into the umbilical
- Pathfinder can be extended on-site with a simple 'Push & Click' to suit different applications
- Wide range of floor, desk and ceiling fixing options to provide total cable management
- Internal segregation for power and data cables

Flexible umbilical in colour options: white and black (silver and clear by request).

Combine PATHFINDER with one of the OE Elsafe cable trays or wire-baskets for optimum cable management.

FIXING BRACKET



CEILING FIXING COLLAR

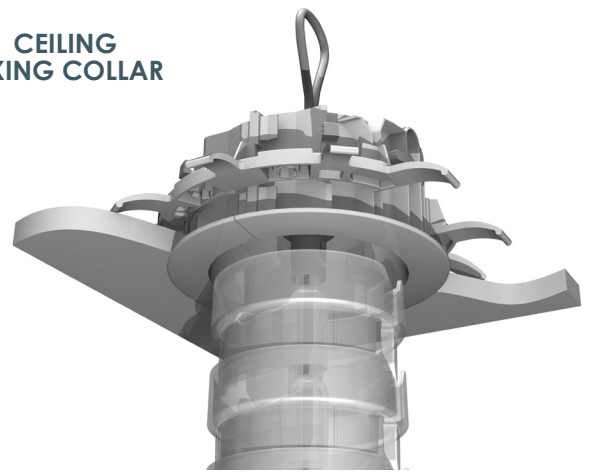

DESK FIXING COLLAR

# pathfinder TECHNICAL

## TOP FIX

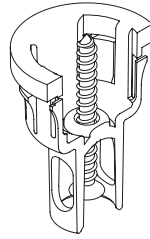
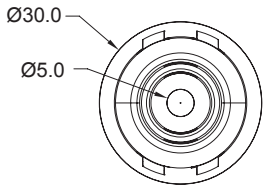

## WEIGHTED BASE



## BOTTOM FIX

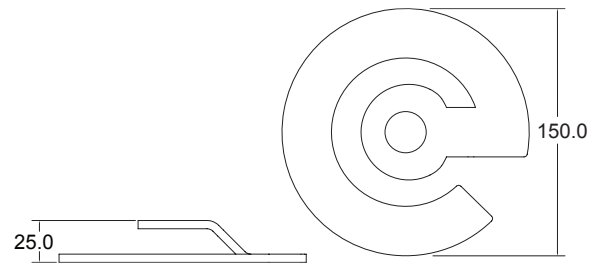
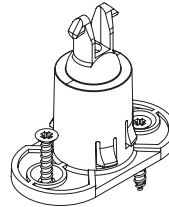
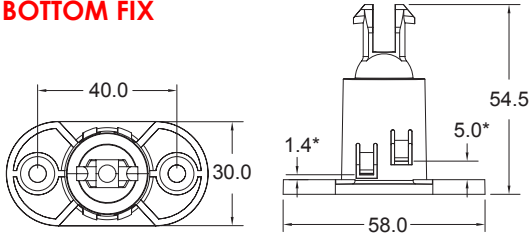

## FLOOR GROMMET

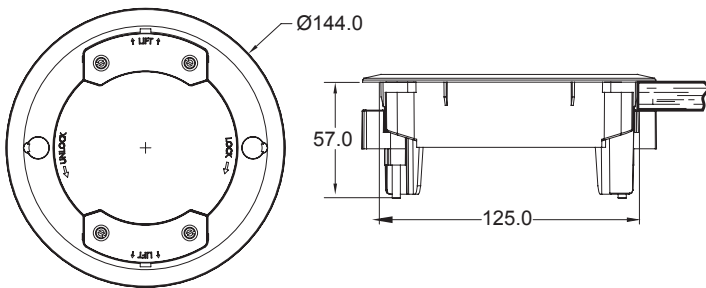

PATHFINDER CABLE AND CONDUIT CAPACITIES				
Cable Size (OD = Outer Diameter)	Cable Type (examples)	Small compartment	Large compartment	Grommet sides (each side)
Cables 6mm OD	eg: CAT5e	19 1	58 1	12 1
Cables 9mm OD	eg: 3 core 1.5mm <sup>2</sup> /CAT6	8 1	26 1	6 1
Cables 11mm OD	eg: 3 core 2.5mm <sup>2</sup>	6 1	17 1	4 1
Conduit 16mm OD	eg: underfloor track tap-off	2 2	6 2	2 2
Conduit 20mm OD	eg: data conduit	1 23	3 23	0
Conduit 25mm OD	eg: data conduit	1 23	1 23	0

GROMMET CUTOUT 125 - 128mm (5inch)

PUSH FIT thicknesses min 10mm

CLAMP FIT thicknesses min 10mm max 50mm

Note: 1 – At 40% fill  
2 – Maximum  
3 – 20mm conduit cannot be inserted with the Zipper  
All capacities reduce if using the Pathfinder Zipper

## CEILING COLLAR

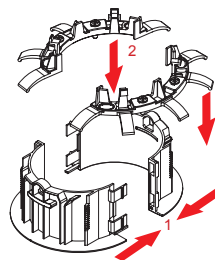
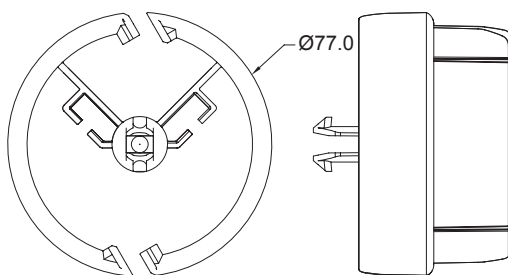

## DESK FLANGE

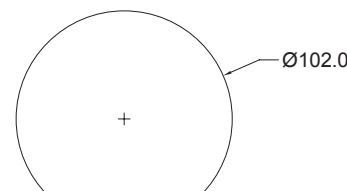

Cutout hole is Ø102mm (4inch) with cutout hole thickness 2-40mm

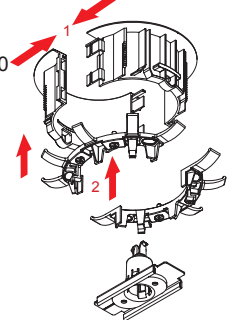

CUTOUT DIMENSIONS (both top & bottom fix)



\* OPTIONAL PANEL THICKNESSES

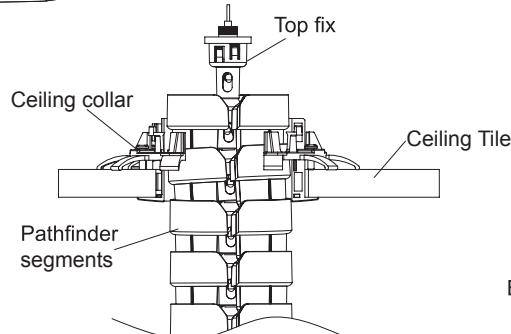

Note: DO NOT hang PATHFINDER from Ceiling Collar, it is only a pass-thru

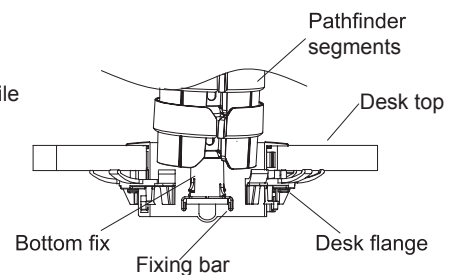

Note: DO NOT use Desk Flange upside down to hang from false ceiling tiles